



สภาฯ
NSTDA

NAC2024
19th NSTDA Annual Conference
การประชุมวิชาการประจำปี สภาฯ ประจำปี ๒๕๖๗

การเสวนา เปิดโลก ERP สำหรับ หน่วยงานรัฐ โดย บริษัทเอกชนไทย

คุณจตุพงษ์ อรุณ
กรรมการผู้จัดการ
บริษัท ไอทีแอสอะเซอร์วิสเซส จำกัด





Odoo Enterprise and Success Case

*IT as a Service Co., Ltd.
Presented by : Jatupong Arun*

Who are we ?



Thailand's leading software house & Odoo partner since 2015



More than

9+

Years of
experience



Trusted by

50+

Clients



Localization App

2+

HR and Accounting

Our services



1. Odoo Implementation & Integration

Gap analysis, custom development, configuration, integration, data migration, testing, training, go-live, support & maintenance.



2. Odoo Training

3-4 days online Odoo technical & functional training courses.

All your business on **one platform.**

Simple, efficient, yet **affordable!**

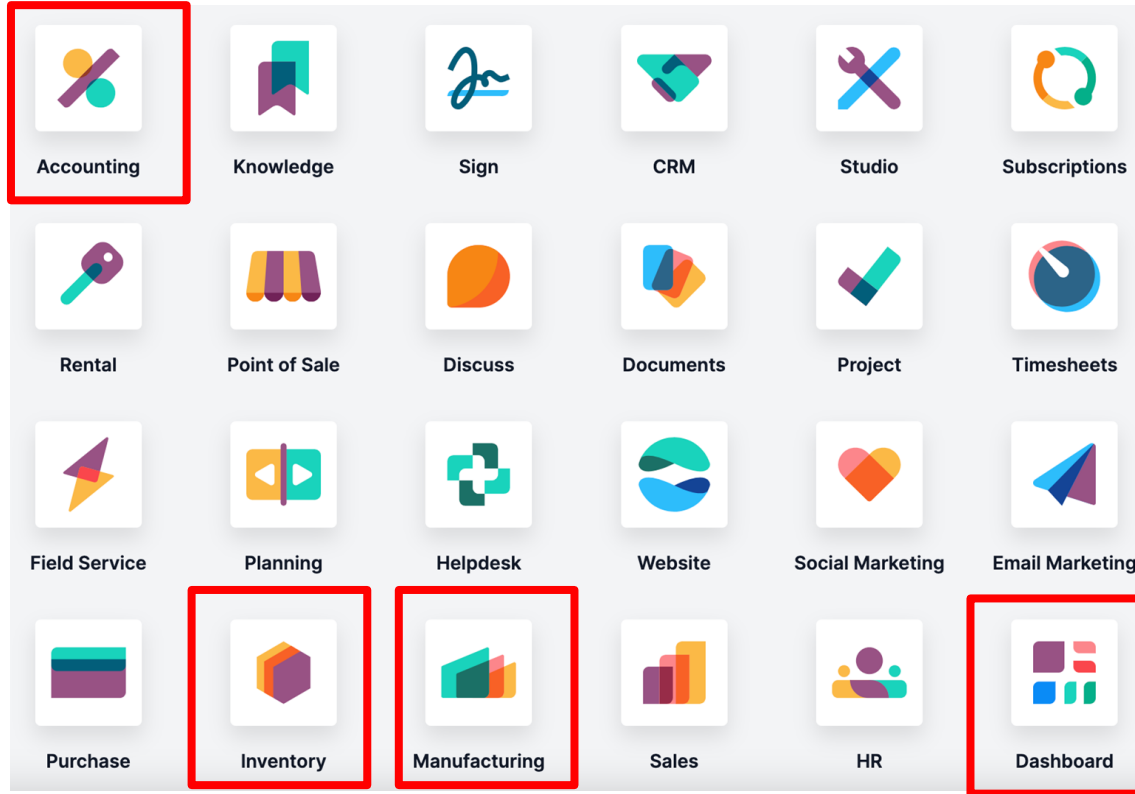

Odoo Enterprise
Application

All Apps
same price

Odoo Enterprise Application Highlight Feature

Inventory

Inventory Overview Operations Products Reporting Configuration

New Order Snooze Order To Max Replenishment

3 selected Actions

1-11/11 < >

LOCATIONS

- All
- Physical Locations 11
 - WH 11
 - WH/Stock 11
 - WH/Stock/Asse... 4
 - WH/Stock/Flat P... 3

<input type="checkbox"/>	Product	Location	On Hand	Forecast	Route	Min ...	Max...	To Order			
<input type="checkbox"/>	[E-COM06] Corner Desk ...	WH/Stock	4.00	-1.00		0.00	0.00	1.00	Order Once	Automate	Snooze
<input checked="" type="checkbox"/>	[E-COM09] Large Desk	WH/Stock	1.00	-4.00		0.00	0.00	4.00	Order Once	Automate	Snooze
<input checked="" type="checkbox"/>	[FURN_9001] Flipover	WH/Stock	5.00	-6.00		0.00	0.00	6.00	Order Once	Automate	Snooze
<input type="checkbox"/>	[FURN_9666] Table	WH/Stock	2.00	-1.00		0.00	0.00	1.00	Order Once	Automate	Snooze

Flawless replenishments

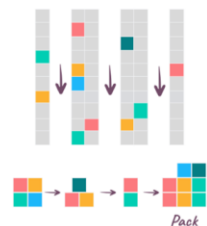

Wave picking



Cluster picking



Batch picking



Replenishment



Quality control



Storage

Odoo Enterprise Application Highlight Feature



Accounting Dashboard Customers Vendors Accounting Reporting Configuration My Company (San Francisco)

Accounting Dashboard

Q Favorites x Search...

1-9 / 9

Accounting

Customer Invoices

[New Invoice](#) 50 Unpaid Invoices \$ 17,675.50
40 Late Invoices \$ 53,877.50

Category	Count	Amount
Due	50	\$ 17,675.50
1 - 7 Oct	40	\$ 53,877.50

Vendor Bills

[Upload](#)
[Create Manually](#)

Miscellaneous Operations

[New Entry](#) Tax return for October 20... 11/07/2023
[Upload](#)

Bank

[Reconcile 8 Items](#) Balance \$ 9,944.87
Last Statement \$ 6,378.00
[Connect Bank](#) Payments \$ 55.70
Misc. Operations \$ 2,500.00

[New Transaction](#)
[Import File](#)

Cash

[New Transaction](#) Balance \$ 2,243.57

Cash Restaurant

[New Transaction](#)

Odoo Enterprise Application Highlight Feature



Manufacturing

The screenshot displays the Odoo Enterprise Manufacturing application interface. At the top, there is a navigation bar with a mobile view icon, a search bar containing 'Ready x' and 'Search...', and a 'Close' button. Below the navigation bar, a list of operators is shown on the left: Michelle Wunderkind, Liz Carr, Toby Cobweb, and Katie Cole. The main area displays four production orders in a grid:

- WH/MO/00024** (In Progress): Peruvian Pure Power (1kg, Ground) - 150 / 150 Units. Progress: Roasting (✓), Grinding (✓), Packaging (0/3). A play button icon is overlaid on the Register-Production row.
- WH/MO/00026** (In Progress): Brazilian Bouncy Brew (5kg, Ground) - 120 / 120 Units. Progress: Roasting (✓), Grinding (Grinding station A →), Register-Production (120 Units).
- WH/MO/00027** (Confirmed): Ethiopian Energy Espresso (250g, Ground) - 250 Units. Progress: Roasting (Roasting B →), Register-Production (250 Units).
- WH/MO/00028** (Confirmed): Peruvian Pure Power (500g, Whole bean) - 200 Units. Progress: Roasting (Roasting A →), Register-Production (200 Units).

Each order card includes a 'Close Production' button and a vertical ellipsis menu. At the bottom left, there is a '+ Add Operator' button.

Odoo Enterprise Application Highlight Feature



Dashboard

SALES	Expenses	To report	To validate	To reimburse
Sales Product	16	\$1,757	\$1,921	\$0

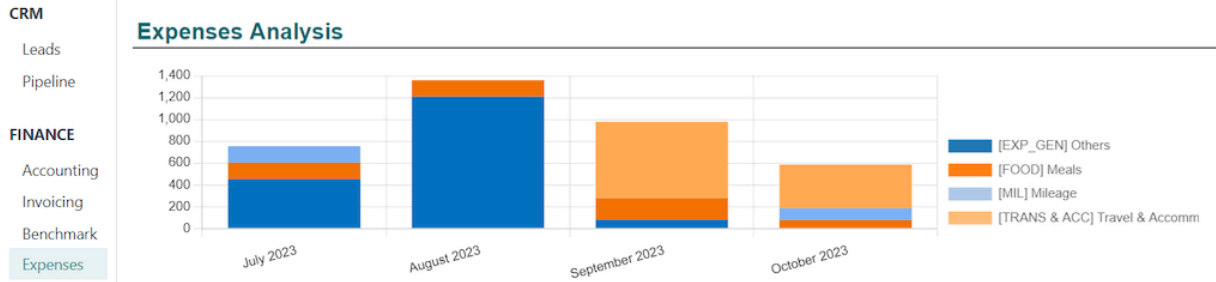

SERVICES

Project
Timesheets

Top Expenses

Expense	Employee	Total
Laptop	Katie Cole	\$889.00
Travel by Air	Katie Cole	\$700.00
Car tyres	Toby Cobweb	\$450.58
Hotel Expenses	Katie Cole	\$400.00
Screen	Katie Cole	\$289.00

Top Categories

Category	# Expenses	Total
[EXP_GEN] Others	6	\$1,738.32
[TRANS & ACC] Travel & Accommodations	2	\$1,100.00
[FOOD] Meals	6	\$578.90
[MIL] Mileage	2	\$260.84

Success Business Case



253 Users
Odoo ERP System



An advertisement for KSG Kings Stella cleaning products. The background is a purple gradient with a faint image of a family (a man, a woman, and a child) smiling. In the foreground, several cleaning products are displayed: a purple spray bottle of King's Stella All Purpose Cleaner, a green bottle of King's Stella All Purpose Cleaner, a red bottle of King's Stella All Purpose Cleaner, a yellow bottle of Kiwi Apple, and a black can of Wax One Easy Foam. The KSG logo is at the top left, and the text "KING'S STELLA" is below it. The main headline reads "EMPOWERING FAMILY LOVERS" in large, bold, white letters. Below the headline, there is a line of Thai text: " Kings Stella ทุกรุ่น บริษัทของครอบครัว ครอบครัวของเรา สู้ครอบครัว เพื่อครอบครัว". At the bottom left, there is a white button with the text "Contact us".

Highlighting Features on Success Case



Inventory

Manage your stock and logistics activities

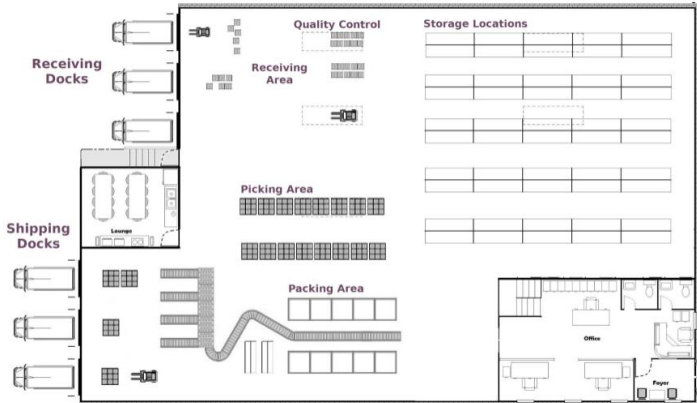

Manufacturing

Manufacturing Orders & BOMs



Shop Floor

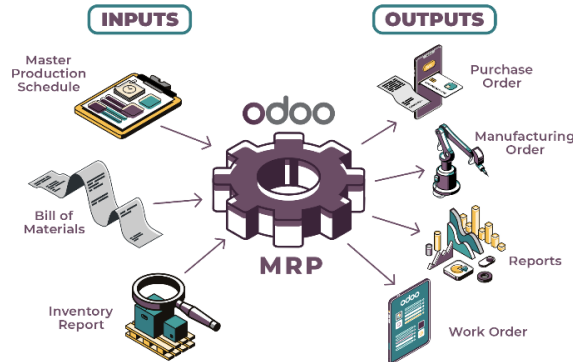

Discuss

Chat, mail gateway and private channels

31

Calendar

Schedule Activity

Task	0 Late	0 Today	1 Future
Expense Report	0 Late	1 Today	0 Future
Purchase Order	1 Late	2 Today	2 Future
Sales Order	1 Late	3 Today	4 Future
Subscription	0 Late	0 Today	1 Future
Notes	0 Late	0 Today	0 Future

Add new note
Request a Document



Inventory

Manage your stock and logistics activities

Inventory Routing for Inbound

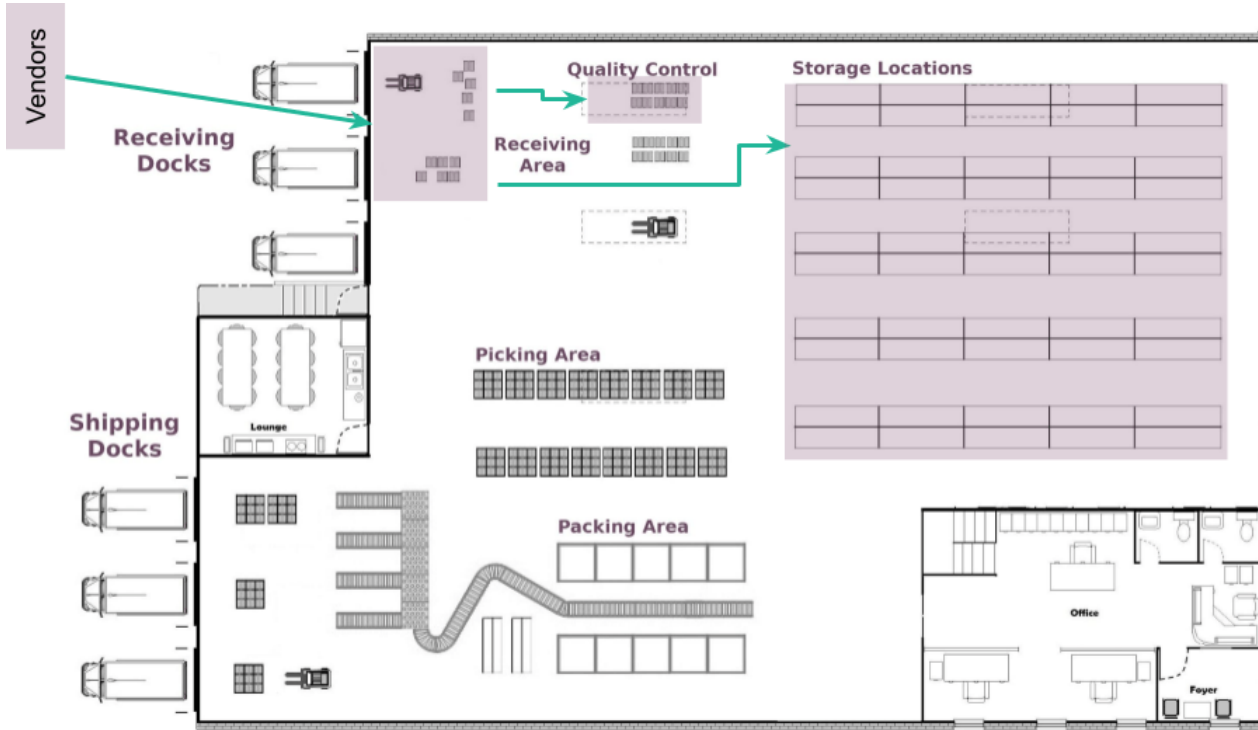

- จัดการสินค้า/วัตถุดิบ
- คลังสินค้าหลายจุด
- จุดรับ จุดตรวจ จัดเก็บ
- Barcode / QR Code
- Storage / Rack / Location

Inventory Routing for Outbound

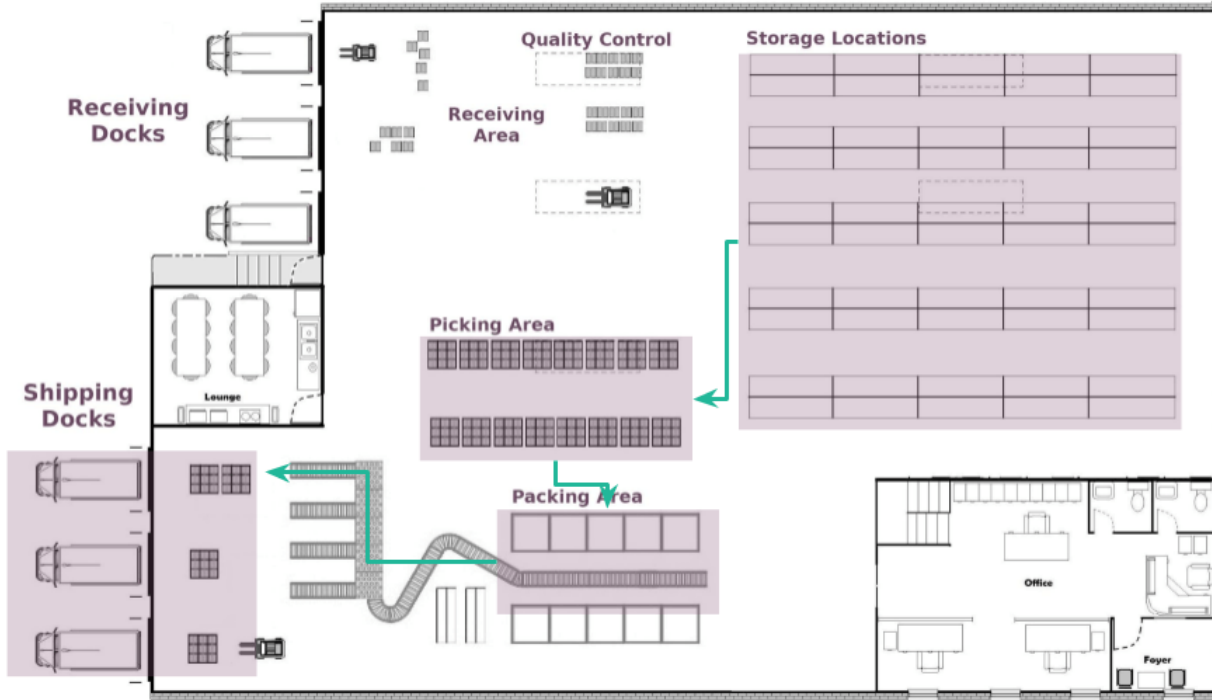

- จัดการสินค้า/สำเร็จรูป
- เบิกจ่ายวัตถุดิบ
- จัดของ นำส่ง ไลน์ผลิต
- จัดของ / Label / Ship
- LOT / FIFO / Expiry / FEFO



Manufacturing

Manufacturing Orders & BOMs

Manufacturing with Shop Floor



Assembly Line 1 **2** Drill Station 1 **1** Assembly Line 2 **0** +

MO Ready X WO Ready or In Pro
Search...

WH/MO/00003 Confirmed [FURN_8522] Table Top - 1 Units	WH/MO/00007 Confirmed [FURN_8522] Table Top - 1 Units	WH/MO/00009 Confirmed [FURN_8855] Drawer - 1 Units
Manual Assembly Assembly Line 1 →	Manual Assembly Assembly Line 1 →	Packing Drill Station 1 →
Register Production +	Register Production +	Register Production +
[FURN_7023] Wood Panel 2 Units	[FURN_7023] Wood Panel 2 Units	[FURN_2100] Drawer Black 1 Units
[FURN_5623] Drawer Case Black 1 Units		
Close Production ⋮	Close Production ⋮	Close Production ⋮

- Real-time Processing
- Real-time Monitoring
- Real Direct Labor (DL)
- Operator Panel
- All Operations in One Screen
- Mobility on Tablet



Discuss

Chat, mail gateway and private channels

Odoo Chat / Log / Notification / Activity

Purchase Orders Products Reporting Configuration

New Requests for Quotation P00015 Receipt

Receive Products Send PO by Email Create Bill Cancel Lock RFQ RFQ Sent Purchase Order

Purchase Order ☆ P00015

Vendor? Ready Mat - US12345675 Confirmation Date 01/29/2024 06:27:44

Vendor Reference? Expected Arrival? 01/30/2024 08:08:49

Blanket Order Ask confirmation

Product	Description	Quantity	Received	Billed	UoM	Unit Price	Taxes	Tax excl.
[FURN_6666] Aco...	[FURN_6666] Acoustic Bloc Screens	20.00	0.00	0.00	Units	286.80	15%	\$ 5,736.00

Add a product Add a section Add a note Catalog

Define your terms and conditions ...

Untaxed Amount: \$ 5,736.00
 Tax 15%: \$ 860.40
 Total: \$ 6,596.40

Send message Log note Activities

Mitchell Admin - now
• RFQ → Purchase Order (Status)

Mitchell Admin - now
Approved as User types / Internal User

Mitchell Admin - now
• Cancelled → RFQ (Status)

Mitchell Admin - now
• RFQ → Cancelled (Status)

Mitchell Admin - now
• Cancelled → RFQ (Status)

Mitchell Admin - now
• Purchase Order → Cancelled (Status)

Mitchell Admin - now
• Locked → Purchase Order (Status)

Mitchell Admin - now
• Purchase Order → Locked (Status)

Mitchell Admin - now
@Marc Demo ตรวจสอบฝ่ายผลิต สามารถส่งวัตถุดิบล่วงหน้าขอราคาแบบ Volume เพิ่มขึ้น

Mitchell Admin - 2 minutes ago
@John doe โบนัสราคาตามแผน

Quotation-SO2023-4148213.pdf PDF

- Activity Log Start/Approve
- Internal Communication
- Attached File / Preview
- Notification / Email Alert
- Future Schedule Activity

How the new gen proposed Odoo
to Senior Management?

What's your favorite/key point ?

Go Paperless with Odoo ERP

Bringing Efficiency & Automation to Your Organization

Example - One of the Workflow



- Integrated System / Approve Anywhere
- Attached File / Log Comment
- Chat Q & A / Revise / Approve
- No-Paper / All Data in Single Platform
- Multi-level Authorize Matrix

Odoo - Our Experience

Manufacturing



Trading Industry



Service Industry



Shop/Restaurant Industry



Construction



Warehouse Management



Contact Us



- Sales Team – Sales@itaas.co.th
- General Information – Info@itaas.co.th
- Tel – 02-125-2516
- Mobile – 091-026-6681, 081-616-7824
- Web – www.itaas.co.th

